



Dynamic 3D Door Hinge

Dynamic Hardware's 3D Door Hinge has been designed to suit PVC-U door profiles and is fully adjustable on all planes.

Manufactured and tested to extremely high standards, the patent-pending Dynamic 3D Door Hinge offers an 'Anti-lift' security feature with a 2.5mm steel sash plate for enhanced performance and security.

SELECTED FEATURES

- Patent pending 'Anti-lift' security feature.
- Supplied ready to fit.
- Dynamic signature dimple indentation.
- Can achieve PAS24 accreditation as part of a (complete) door assembly.
- All painted finishes are UV stabilised.
- Manufactured in high strength Aluminium, Zinc alloys, Steel and 304 Stainless Steel.
- 2.5mm Steel/Stainless Steel sash plate for superior strength.
- 3D independent vertical, lateral and compression adjustment.
- Non-Handed.
- Available in 19mm and 22mm height options. Variety of hinge packers available.
- 12 colours as standard.
- All adjustments carried out with one size 5mm allen key.
- Only one size 4mm drill bit required in all prep work.
- Alternative packaging available to suit high volume manufacturing.



The **Dynamic 3D Door Hinge** is quick to fit and suitable for use on PVC-U doors.

STRENGTH IN PRODUCT DESIGN



Dynamic Hardware

PART NUMBERS

Part Number	Description	Box Quantity	Carton Quantity
DYFH-19AG	19mm Anthracite Grey	1	24
DYFH-19BK	19mm Black	1	24
DYFH-19BN	19mm Brown	1	24
DYFH-19OK	19mm Oak	1	24
DYFH-19SV	19mm Silver	1	24
DYFH-19WH	19mm White	1	24
DYFH-19CG	19mm Champagne Gold	1	24
DYFH-19CH	19mm Chrome	1	24
DYFH-19BZ	19mm Bronze	1	24
DYFH-19SA	19mm Satin Chrome	1	24
DYFH-19GP	19mm Pewter	1	24
DYFH-19GD	19mm Dark Gold	1	24
DYFH-22AG	22mm Anthracite Grey	1	24
DYFH-22BK	22mm Black	1	24
DYFH-22BN	22mm Brown	1	24
DYFH-22OK	22mm Oak	1	24
DYFH-22SV	22mm Silver	1	24
DYFH-22WH	22mm White	1	24
DYFH-22CG	22mm Champagne Gold	1	24
DYFH-22CH	22mm Chrome	1	24
DYFH-22BZ	22mm Bronze	1	24
DYFH-22SA	22mm Satin Chrome	1	24
DYFH-22GP	22mm Pewter	1	24
DYFH-22GD	22mm Dark Gold	1	24
DYFH-P1BK	1mm Black Packer	1	24
DYFH-P1WH	1mm White Packer	1	24
DYFH-P2BK	2mm Black Packer	1	24
DYFH-P2WH	2mm White Packer	1	24
DYFH-JIG	Hinge Jig	1	24

FINISHES

All UV Stabilised.

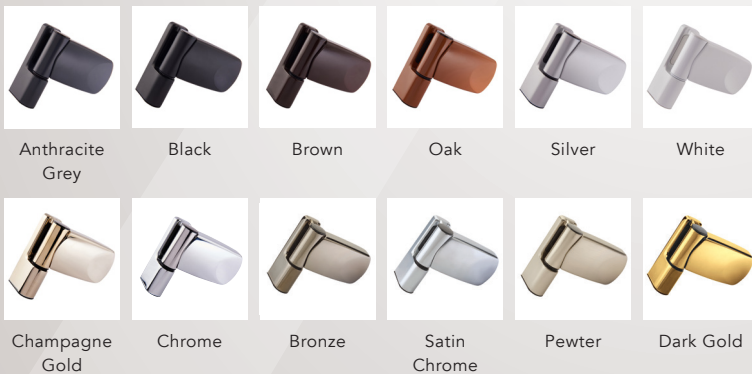

Guarantee subject to correct installation and maintenance.

MATERIAL SPECIFICATION

- Zinc alloy.
- Aluminum alloy.
- Steel.
- Stainless Steel Grade 304.
- Plastic – GF Nylon, UV Stabilised ABS and Acetal.
- All painted finishes are UV Stabilised.



3D ADJUSTMENT

- Vertical +4mm.
- Compression +/-1mm.
- Lateral +/-6mm.

TESTING

- Corrosion tested to BS EN 1670.
- Grade 5 painted and plated finishes.
- Cycle tested to 100,000 cycles, conforms to BS EN1191.
- PAS24 compatible when tested as part of a complete door assembly.

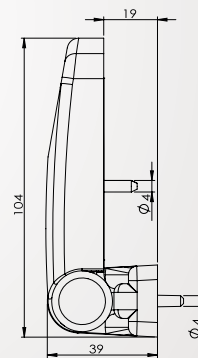
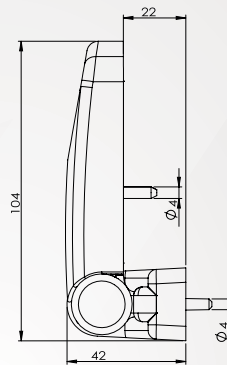

MAXIMUM WEIGHT CARRYING CAPACITY

- 2 hinges 80kg
- 3 hinges 100kg.

MAXIMUM DOOR SIZE

- Approximately 1m wide x 2.2m high.



Dynamic Hardware

T: **01922 907776** | E: info@dynamicgrouplimited.com

Dynamic HW Group Limited 8 Windmill Street, Walsall, West Midlands, WS1 3EE

www.dynamichardware.co.uk