



# Dynamic 3D Door Hinge

Dynamic Hardware's 3D Door Hinge has been designed to suit PVC-U door profiles and is fully adjustable on all planes.

Manufactured and tested to extremely high standards, the patent-pending Dynamic 3D Door Hinge offers an 'Anti-lift' security feature with a 2.5mm steel sash plate for enhanced performance and security.

## SELECTED FEATURES

- Patent pending 'Anti-lift' security feature.
- Supplied ready to fit.
- Dynamic signature dimple indentation.
- PAS24 accredited as part of a door assembly/can achieve PAS24 accreditation as part of a (complete) door assembly.
- Manufactured in high strength Aluminium, Zinc alloys, Steel and 304 Stainless Steel.
- 2.5mm Steel/Stainless Steel sash plate for superior strength.
- 3D independent vertical, lateral and compression adjustment.
- Non-Handed.
- Available in 19mm and 22mm height options. Variety of hinge packers available.
- 11 colours as standard.
- All adjustments carried out with one size 5mm allen key.
- Only one size 4mm drill bit required in all prep work.
- Alternative packaging available to suit high volume manufacturing.



The **Dynamic 3D Door Hinge** is quick to fit and suitable for use on PVC-U doors.

STRENGTH IN PRODUCT DESIGN



Dynamic Hardware

## PART NUMBERS

Part Number	Description	Box Quantity	Carton Quantity
EFH – 19AG	19mm Anthracite Grey	1	24
EFH – 19BK	19mm Black	1	24
EFH – 19BN	19mm Brown	1	24
EFH – 19OK	19mm Oak	1	24
EFH – 19SV	19mm Silver	1	24
EFH – 19WH	19mm White	1	24
EFH – 19CG	19mm Champagne Gold	1	24
EFH – 19CH	19mm Chrome	1	24
EFH – 19SA	19mm Satin Chrome	1	24
EFH – 19BZ	19mm Bronze	1	24
EFH – 19GP	19mm Pewter	1	24
EFH – FL19CH	19mm Chrome	N/A	24
EFH – FL19WH	19mm White	N/A	24
EFH – 22AG	22mm Anthracite Grey	1	24
EFH – 22BK	22mm Black	1	24
EFH – 22BN	22mm Brown	1	24
EFH – 22OK	22mm Oak	1	24
EFH – 22SV	22mm Silver	1	24
EFH – 22WH	22mm White	1	24
EFH – 22CG	22mm Champagne Gold	1	24
EFH – 22CH	22mm Chrome	1	24
EFH – 22SA	22mm Satin Chrome	1	24
EFH – 22BZ	22mm Bronze	1	24
EFH – 22GP	22mm Pewter	1	24
EFH – P1BK	1mm Black Packer	1	24
EFH – P1WH	1mm White Packer	1	24
EFH – P2BK	2mm Black Packer	1	24
EFH – P2WH	2mm White Packer	1	24
EFH – JIG	Hinge Jig	1	24

## MATERIAL SPECIFICATION

- Zinc alloy.
- Aluminum alloy.
- Steel.
- Stainless Steel Grade 304.
- Plastic – GF Nylon, UV Stabilised ABS and Acetal.

## 3D ADJUSTMENT

- Vertical + 6mm (+/-3mm).
- Compression +/- 1mm.
- Lateral +/- 6mm.

## MAXIMUM DOOR SIZE

- Approximately 1m wide x 2.2m high.

## TESTING

- Corrosion tested to BS EN 1670\*.
- Grade 4 plated finishes.
- Grade 5 painted finishes.
- Cycle tested to 100,000 cycles, conforms to BS EN1191.
- PAS24 compatible when tested as part of a complete door assembly.

## MAXIMUM WEIGHT CARRYING CAPACITY

- 2 hinges 80kg  
– 3 hinges 120kg.

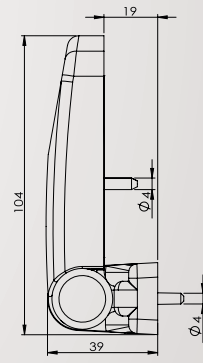
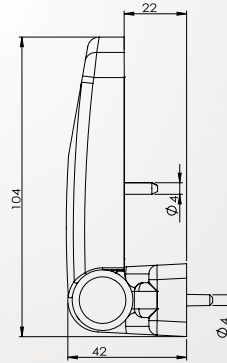

## FINISHES

All UV Stabilised.



\* Guarantee subject to correct installation and maintenance.

T: **01922 907776** | E: **info@dynamicgrouplimited.com**



**Dynamic Hardware**